

American Standard (ANSI) Chain Conveyor Chain Attachments

A-1

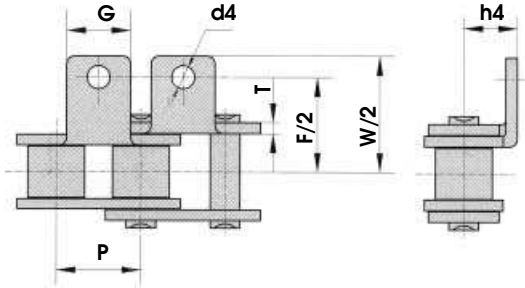

Bent Lugs One Side

K-1

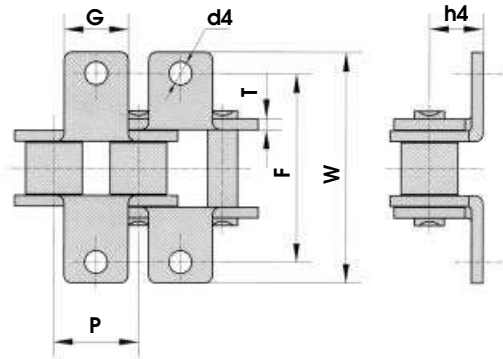

Bent Lugs Both Sides

| ANSI Chain No. | P | G | F | W | T | h4 | d4 |
|----------------|-------|-------|-------|-------|-------|-------|-------|
| 35 | 0.375 | 0.311 | 0.748 | 1.126 | 0.051 | 0.250 | 0.134 |
| 40 | 0.500 | 0.374 | 1.000 | 1.386 | 0.059 | 0.311 | 0.134 |
| 41 | 0.500 | 0.374 | 0.945 | 1.315 | 0.051 | 0.272 | 0.142 |
| 50 | 0.625 | 0.500 | 1.250 | 1.819 | 0.080 | 0.406 | 0.217 |
| 60 | 0.750 | 0.626 | 1.500 | 2.189 | 0.095 | 0.469 | 0.217 |
| 80 | 1.000 | 0.752 | 2.000 | 2.551 | 0.128 | 0.626 | 0.268 |
| 100 | 1.250 | 1.000 | 2.500 | 3.437 | 0.157 | 0.780 | 0.362 |
| 120 | 1.500 | 1.126 | 3.000 | 4.272 | 0.189 | 0.906 | 0.386 |
| 140 | 1.750 | 1.374 | 3.500 | 4.843 | 0.220 | 1.126 | 0.449 |
| 160 | 2.000 | 1.500 | 4.000 | 5.622 | 0.252 | 1.250 | 0.516 |
| 200 | 2.500 | 2.000 | 5.000 | 7.047 | 0.315 | 1.688 | 0.642 |

American Standard (ANSI) Chain Conveyor Chain Attachments

SA-1

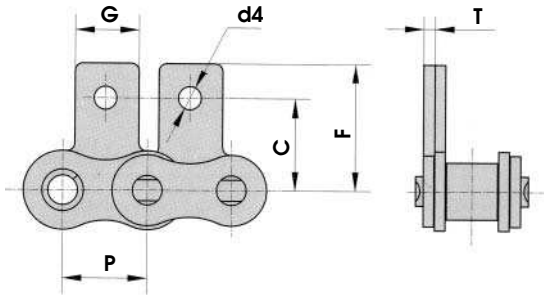

SA-1 (M35) Straight Lugs One Side

SK-1

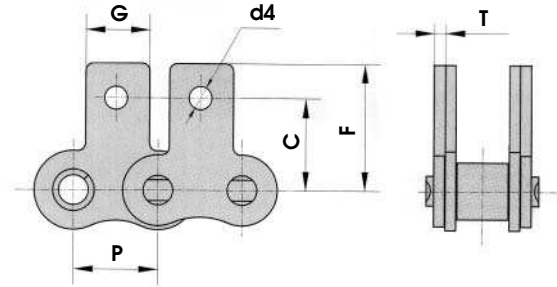

SK-1 (M35) Straight Lugs Both Sides

| ANSI Chain No. | P | G | C | F | T | d4 |
|----------------|-------|-------|-------|-------|-------|-------|
| 35 | 0.375 | 0.311 | 0.374 | 0.573 | 0.051 | 0.134 |
| 40 | 0.500 | 0.374 | 0.500 | 0.750 | 0.059 | 0.134 |
| 41 | 0.500 | 0.374 | 0.467 | 0.652 | 0.051 | 0.142 |
| 50 | 0.625 | 0.500 | 0.626 | 0.994 | 0.080 | 0.217 |
| 60 | 0.750 | 0.626 | 0.720 | 1.155 | 0.095 | 0.217 |
| 80 | 1.000 | 0.752 | 0.969 | 1.366 | 0.128 | 0.268 |
| 100 | 1.250 | 1.000 | 1.252 | 1.705 | 0.157 | 0.362 |
| 120 | 1.500 | 1.126 | 1.437 | 2.031 | 0.189 | 0.386 |
| 140 | 1.750 | 1.374 | 1.752 | 2.441 | 0.220 | 0.449 |
| 160 | 2.000 | 1.500 | 2.000 | 2.750 | 0.252 | 0.516 |
| 200 | 2.500 | 2.000 | 2.500 | 3.500 | 0.315 | 0.642 |

American Standard (ANSI) Chain Conveyor Chain Attachments

WA-1

WA-2

WK-1

WK-2

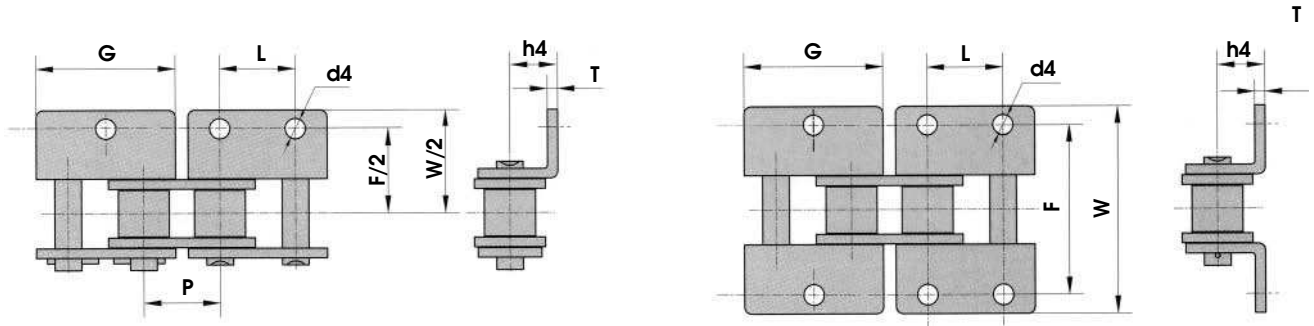

| ANSI Chain No. | P | G | L | F | W | T | h4 | d4 |
|----------------|-------|-------|-------|-------|-------|-------|-------|-------|
| 35 | 0.375 | 0.682 | 0.375 | 0.748 | 1.126 | 0.051 | 0.250 | 0.110 |
| 40 | 0.500 | 0.906 | 0.500 | 1.000 | 1.402 | 0.059 | 0.311 | 0.134 |
| 41 | 0.500 | 0.878 | 0.500 | 0.945 | 1.378 | 0.051 | 0.283 | 0.191 |
| 50 | 0.625 | 1.134 | 0.625 | 1.250 | 1.843 | 0.080 | 0.406 | 0.217 |
| 60 | 0.750 | 1.364 | 0.750 | 1.500 | 2.220 | 0.095 | 0.469 | 0.217 |
| 80 | 1.000 | 1.807 | 1.000 | 2.000 | 2.882 | 0.128 | 0.626 | 0.268 |
| 100 | 1.250 | 2.270 | 1.250 | 2.500 | 3.535 | 0.157 | 0.780 | 0.362 |
| 120 | 1.500 | 2.728 | 1.500 | 3.000 | 4.283 | 0.189 | 0.906 | 0.386 |
| 140 | 1.750 | 3.167 | 1.750 | 3.500 | 4.843 | 0.220 | 1.126 | 0.449 |
| 160 | 2.000 | 3.622 | 2.000 | 4.000 | 5.622 | 0.252 | 1.250 | 0.516 |
| 200 | 2.500 | 4.547 | 2.500 | 5.000 | 7.047 | 0.315 | 1.688 | 0.642 |

American Standard (ANSI) Chain Conveyor Chain Attachments

WSA-1

WSA-2

WSK-1

WSK-

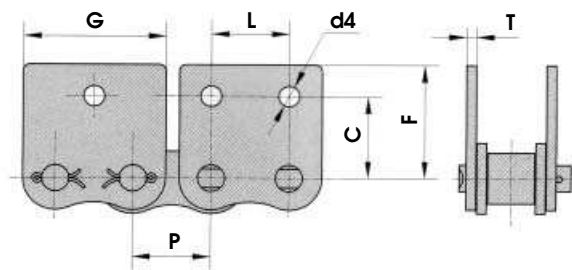
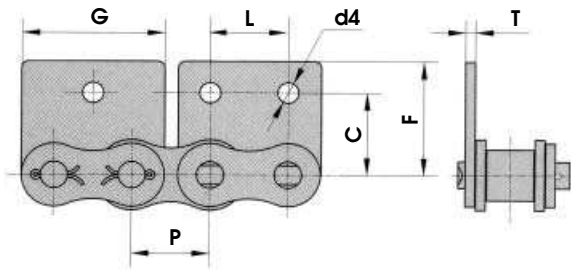

| ANSI Chain No. | P | G | L | C | F | T | d4 |
|----------------|-------|-------|-------|-------|-------|-------|-------|
| 35 | 0.375 | 0.682 | 0.375 | 0.374 | 0.573 | 0.051 | 0.110 |
| 40 | 0.500 | 0.906 | 0.500 | 0.500 | 0.685 | 0.059 | 0.134 |
| 41 | 0.500 | 0.835 | 0.500 | 0.467 | 0.652 | 0.051 | 0.142 |
| 50 | 0.625 | 1.134 | 0.625 | 0.626 | 0.907 | 0.080 | 0.217 |
| 60 | 0.750 | 1.364 | 0.750 | 0.720 | 1.057 | 0.095 | 0.217 |
| 80 | 1.000 | 1.807 | 1.000 | 0.969 | 1.396 | 0.128 | 0.268 |
| 100 | 1.250 | 2.270 | 1.250 | 1.252 | 1.732 | 0.157 | 0.362 |
| 120 | 1.500 | 2.728 | 1.500 | 1.437 | 2.031 | 0.189 | 0.386 |
| 140 | 1.750 | 3.167 | 1.750 | 1.752 | 2.441 | 0.220 | 0.449 |
| 160 | 2.000 | 3.622 | 2.000 | 2.000 | 2.750 | 0.252 | 0.516 |
| 200 | 2.500 | 4.547 | 2.500 | 2.500 | 3.500 | 0.315 | 0.642 |

American Standard (ANSI) Chain Conveyor Chain Attachments

AA-1

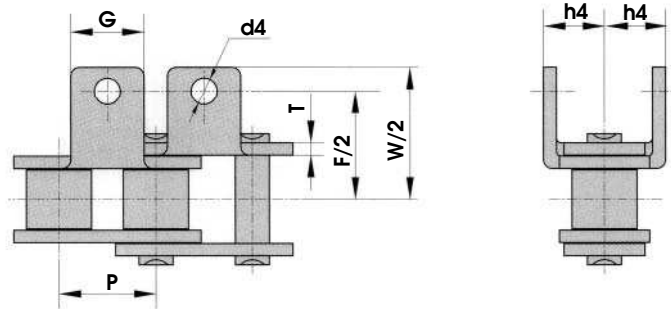

KK-1

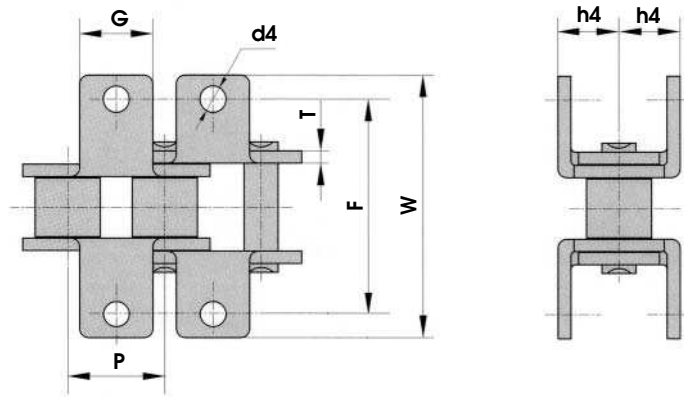

| ANSI Chain No. | P | G | F | W | T | h4 | d4 |
|----------------|-------|-------|-------|-------|-------|-------|-------|
| 40 | 0.500 | 0.374 | 1.000 | 1.386 | 0.059 | 0.311 | 0.134 |
| 50 | 0.625 | 0.500 | 1.250 | 1.819 | 0.080 | 0.406 | 0.217 |
| 60 | 0.750 | 0.626 | 1.500 | 2.189 | 0.095 | 0.469 | 0.217 |
| 80 | 1.000 | 0.752 | 2.000 | 2.551 | 0.128 | 0.626 | 0.268 |
| 100 | 1.250 | 1.000 | 2.500 | 3.437 | 0.157 | 0.780 | 0.362 |

American Standard (ANSI) Chain Conveyor Chain Attachments

SAA-1

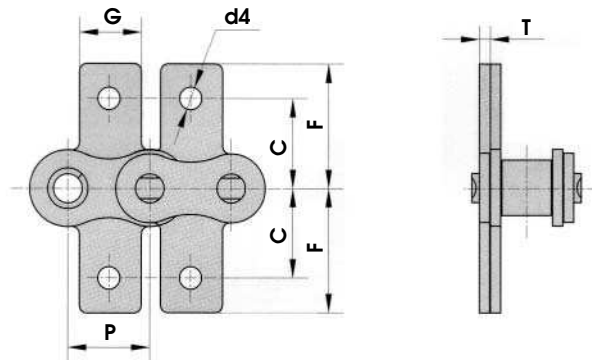

SKK-1

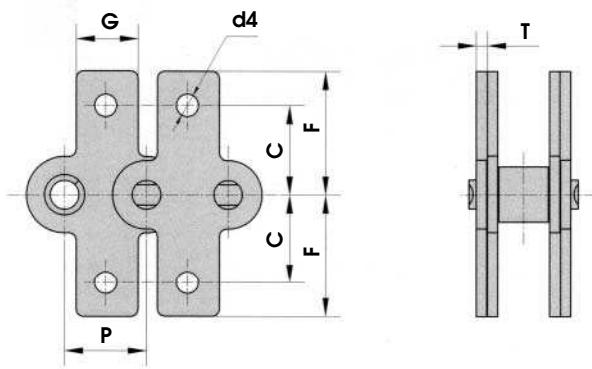

| ANSI Chain No. | P | G | C | F | T | d4 |
|----------------|-------|-------|-------|-------|-------|-------|
| 40 | 0.500 | 0.374 | 0.500 | 0.750 | 0.059 | 0.134 |
| 50 | 0.625 | 0.500 | 0.626 | 0.994 | 0.080 | 0.217 |
| 60 | 0.750 | 0.626 | 0.720 | 1.155 | 0.095 | 0.217 |
| 80 | 1.000 | 0.752 | 0.969 | 1.366 | 0.128 | 0.268 |
| 100 | 1.250 | 1.000 | 1.252 | 1.705 | 0.157 | 0.362 |