

Metric Stainless Steel Gears

20° Pressure Angle

DIN 782

Material: Stainless Steel 1.4305 (AISI 303)

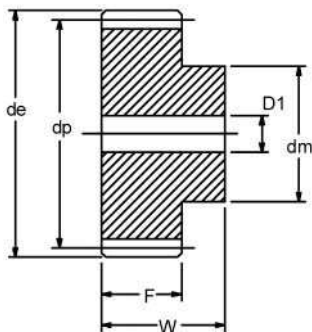

Spur Gears

| Part No. | Module | Teeth | Tooth Face F | Width W | Outside Ø de | Pitch Ø dp | Hub Ø dm | Bore Ø D1 ±1 mm | Weight kg |
|-----------|--------|-------|--------------|---------|--------------|------------|----------|-----------------|-----------|
| SSM1B15 | 1 | 15 | 8 | 18 | 17.0 | 15.0 | 12 | 5 | 0.016 |
| SSM1B20 | 1 | 20 | 8 | 18 | 22.0 | 20.0 | 15 | 6 | 0.027 |
| SSM1B25 | 1 | 25 | 8 | 18 | 27.0 | 25.0 | 18 | 6 | 0.045 |
| SSM1B30 | 1 | 30 | 8 | 18 | 32.0 | 30.0 | 20 | 8 | 0.059 |
| SSM1B40 | 1 | 40 | 8 | 18 | 42.0 | 40.0 | 25 | 8 | 0.108 |
| SSM1B60 | 1 | 60 | 8 | 18 | 62.0 | 60.0 | 40 | 10 | 0.260 |
| SSM1.5B15 | 1.5 | 15 | 12 | 25 | 25.5 | 22.5 | 18 | 6 | 0.057 |
| SSM1.5B20 | 1.5 | 20 | 12 | 25 | 33.0 | 30.0 | 20 | 8 | 0.097 |
| SSM1.5B25 | 1.5 | 25 | 12 | 25 | 40.5 | 37.5 | 25 | 8 | 0.142 |
| SSM1.5B30 | 1.5 | 30 | 12 | 25 | 48.0 | 45.0 | 30 | 10 | 0.195 |
| SSM1.5B40 | 1.5 | 40 | 12 | 25 | 63.0 | 60.0 | 40 | 10 | 0.355 |
| SSM1.5B60 | 1.5 | 60 | 12 | 25 | 93.0 | 90.0 | 60 | 12 | 0.815 |
| SSM2B15 | 2 | 15 | 16 | 30 | 34.0 | 30.0 | 24 | 8 | 0.118 |
| SSM2B20 | 2 | 20 | 16 | 30 | 44.0 | 40.0 | 28 | 10 | 0.195 |
| SSM2B25 | 2 | 25 | 16 | 30 | 54.0 | 50.0 | 30 | 10 | 0.285 |
| SSM2B30 | 2 | 30 | 16 | 30 | 64.0 | 60.0 | 40 | 12 | 0.448 |
| SSM2B40 | 2 | 40 | 16 | 30 | 84.0 | 80.0 | 50 | 12 | 0.760 |
| SSM2B60 | 2 | 60 | 16 | 30 | 124.0 | 120.0 | 80 | 15 | 1.910 |
| SSM3B15 | 3 | 15 | 25 | 40 | 51.0 | 45.0 | 30 | 12 | 0.375 |
| SSM3B20 | 3 | 20 | 25 | 40 | 66.0 | 60.0 | 40 | 15 | 0.600 |
| SSM3B25 | 3 | 25 | 25 | 40 | 81.0 | 75.0 | 50 | 15 | 0.955 |
| SSM3B30 | 3 | 30 | 25 | 40 | 96.0 | 90.0 | 60 | 20 | 1.450 |
| SSM3B40 | 3 | 40 | 25 | 40 | 126.0 | 120.0 | 80 | 20 | 2.980 |
| SSM3A60 | 3 | 60 | 25 | — | 186.0 | 180.0 | — | 25 | 4.840 |
| SSM4B15 | 4 | 15 | 32 | 50 | 68.0 | 60.0 | 45 | 15 | 0.796 |
| SSM4B20 | 4 | 20 | 32 | 50 | 88.0 | 80.0 | 50 | 20 | 1.383 |
| SSM4B25 | 4 | 25 | 32 | 50 | 108.0 | 100.0 | 60 | 20 | 2.220 |
| SSM4B30 | 4 | 30 | 32 | 50 | 128.0 | 120.0 | 80 | 25 | 3.290 |
| SSM4A40 | 4 | 40 | 32 | — | 168.0 | 160.0 | — | 25 | 4.920 |
| SSM4A60 | 4 | 60 | 32 | — | 248.0 | 240.0 | — | 30 | 11.060 |

Note: "A" type gears with out hub.

Note: "B" type gears with hub.