

# Metric Nylon Gears

20° Pressure Angle

DIN 782

Material: Nylon P 6.6

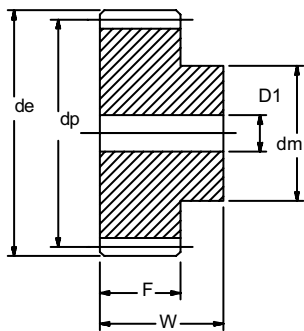

## Spur Gears

Part No.	Module	Teeth	Tooth Face F	Width W	Outside Ø de	Pitch Ø dp	Hub Ø dm	Bore Ø D1 ±1 mm	Weight kg
NM1B15	1	15	8	18	17.0	15.0	12	5	0.002
NM1B16	1	16	8	18	18.0	16.0	12	5	0.002
NM1B18	1	18	8	18	20.0	18.0	15	6	0.003
NM1B20	1	20	8	18	22.0	20.0	15	6	0.004
NM1B24	1	24	8	18	26.0	24.0	18	6	0.006
NM1B25	1	25	8	18	27.0	25.0	18	6	0.006
NM1.5B15	1.5	15	12	25	25.5	22.5	18	6	0.057
NM1.5B16	1.5	16	12	25	27.0	24.0	18	6	0.060
NM1.5B18	1.5	18	12	25	30.0	27.0	20	8	0.073
NM1.5B20	1.5	20	12	25	33.0	30.0	20	8	0.097
NM1.5B24	1.5	24	12	25	39.0	36.0	25	8	0.135
NM1.5B25	1.5	25	12	25	40.5	37.5	25	8	0.142
NM2B15	2	15	16	30	34.0	30.0	24	8	0.118
NM2B16	2	16	16	30	36.0	32.0	25	8	0.134
NM2B18	2	18	16	30	40.0	36.0	28	10	0.166
NM2B20	2	20	16	30	44.0	40.0	28	10	0.195
NM2B24	2	24	16	30	52.0	48.0	30	10	0.272
NM2B25	2	25	16	30	54.0	50.0	30	10	0.285
NM2.5B15	2.5	15	20	35	42.5	37.5	25	10	0.200
NM2.5B16	2.5	16	20	35	45.0	40.0	25	10	0.225
NM2.5B18	2.5	18	20	35	50.0	45.0	30	12	0.286
NM2.5B20	2.5	20	20	35	55.0	50.0	30	12	0.340
NM2.5B24	2.5	24	20	35	65.0	60.0	40	12	0.515
NM2.5B25	2.5	25	20	35	67.5	62.5	40	12	0.550